

# FASTBALL™

## Ball Mount & Magnetic Phone Socket

**IMPORTANT SAFETY INSTRUCTIONS, READ AND FOLLOW ALL WARNINGS AND INSTRUCTIONS BEFORE USING THIS PRODUCT. INJURY CAN RESULT FROM IMPROPER USE. SAVE THESE INSTRUCTIONS.**



PRODUCT MAY VARY FROM IMAGES SHOWN

### TABLE OF CONTENTS

Warnings .....	2
Product Components .....	3
How To Install Magnetic Phone Socket .....	4
How To Install Ball Mount .....	5
How To Remove .....	6
How To Reinstall.....	6

### WARNING

- **STORE OUT OF REACH OF CHILDREN. THIS PRODUCT IS NOT A TOY.**
- Choking Hazard – Children under 3 years or any individuals who have a tendency to place inedible objects in their mouths.
- **Strong magnet included.** Keep phone socket [6 inches (15cm)] away from implanted medical devices. Magnetic field may affect the operation of pacemakers and implantable cardioverter defibrillators (ICDs). If you have a pacemaker or ICD, consult a doctor before using this product.

### NOTICE

- FastBall™ is not intended for use on any textured surface (e.g., faux leather surfaces). Texture will interfere with adhesion.
- **DO NOT** install FastBall™ on any surface that has preexisting damage such as cracks or faded colors. Doing so will cause further damage to the surface.
- While cleaning your car’s dash, avoid cleaners that may scratch or corrode your car’s dash.
- After removal, you may notice color changes on your car’s dash.
- FastBall™ includes strong magnet, but solid state hard drives, such as are in many modern smart phones and portable electronic devices, should not be damaged.
- Pacemakers, magnetic stripe cards, magnetic storage media, VCRs, computer and television screens, and other magnet sensitive items can be damaged by the product’s strong magnet. The product should be kept away from such objects. BulbHead expressly disclaims all liability for damage caused by the magnet coming into proximity with magnet-sensitive items.

### PRODUCT COMPONENTS

- A. Magnetic Phone Socket
- B. Ball Mount
- C. Replacement Socket 3M Adhesive
- D. Replacement Mount 3M Adhesive
- E. Alcohol Prep Pad

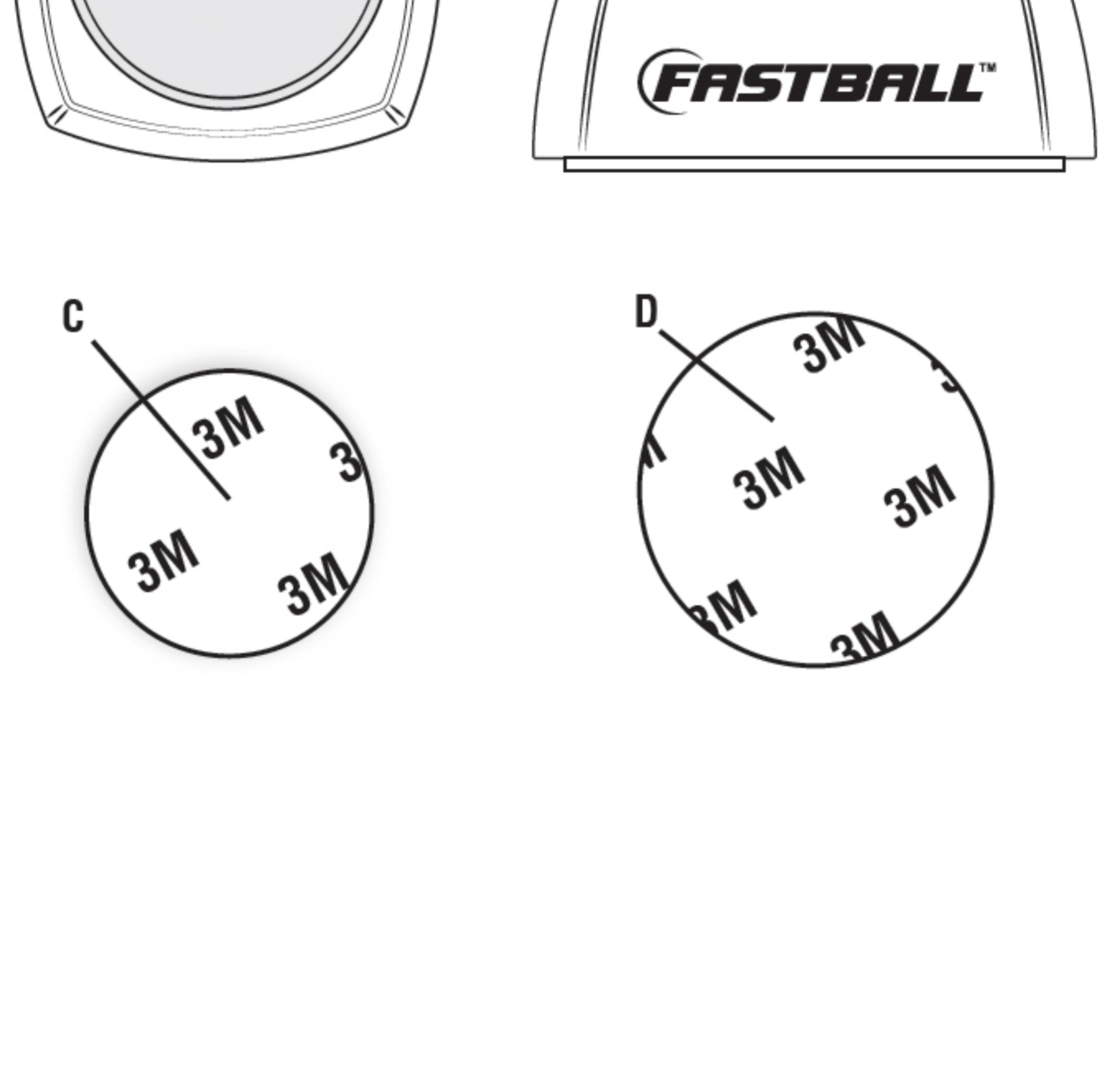

### HOW TO INSTALL MAGNETIC PHONE SOCKET

**NOTE:** For use directly on phone backs and on hard, not easily bendable, phone cases.

1. Start by cleaning the back of your phone or phone case with a damp cloth. (Figure A)

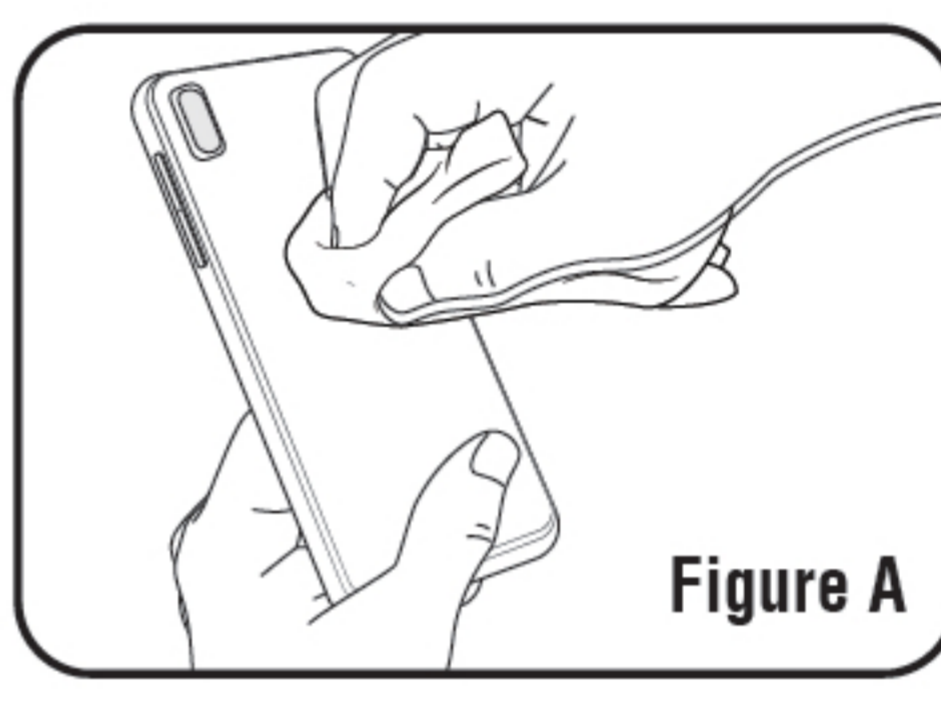

**NOTE:** After phone’s surface is thoroughly clean make sure surface is completely dry before adhering phone socket.

2. Once your phone is clean, simply peel off the protective film on the back of the socket (Figure B), and press it down firmly to the center of the back of your phone. (Figure C)

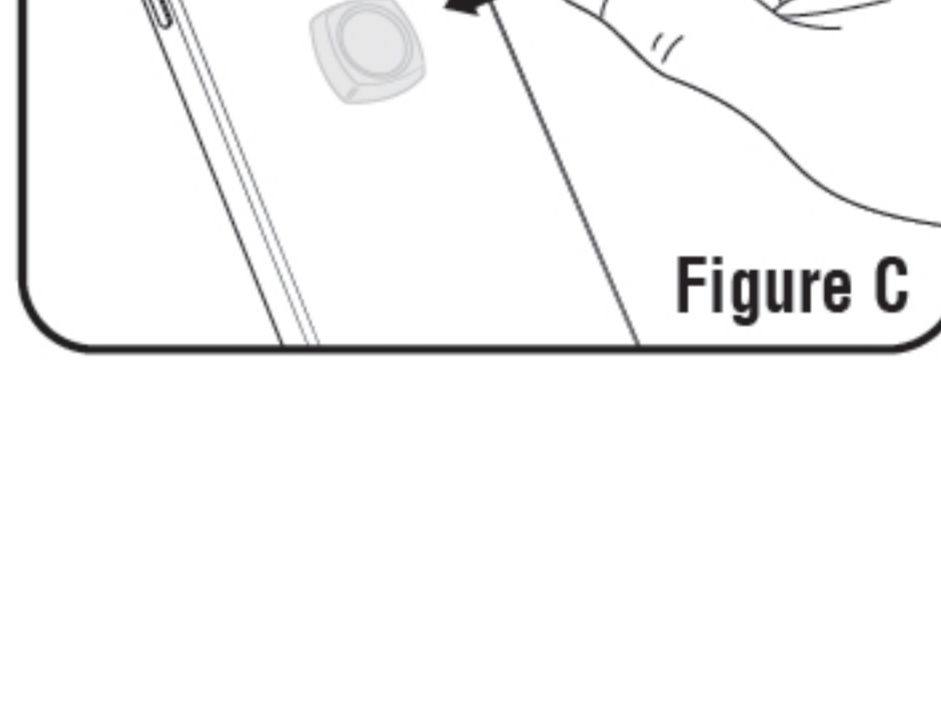
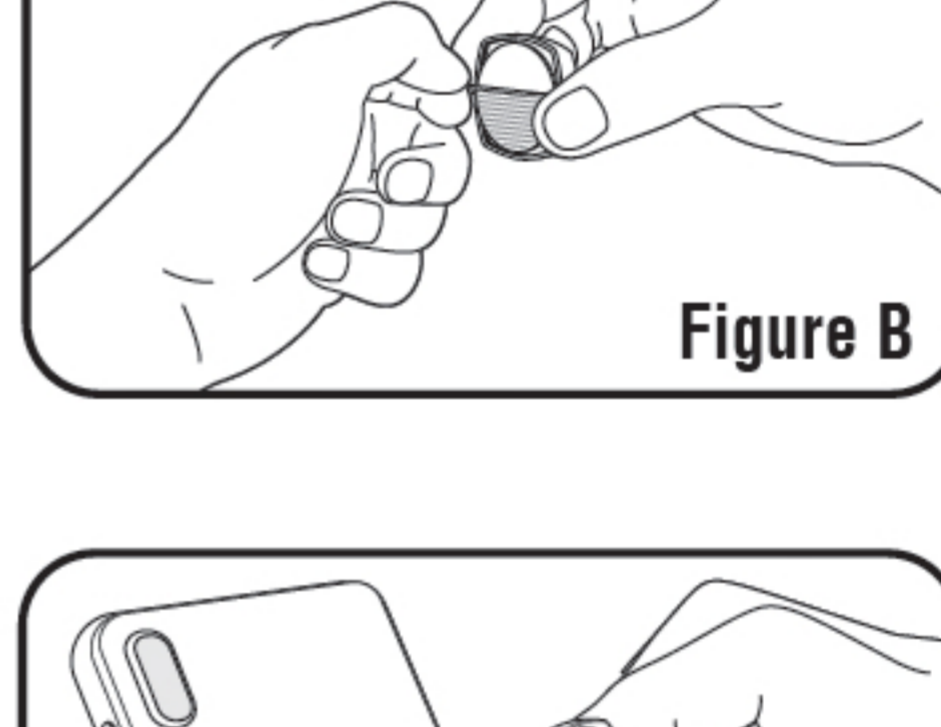

**IMPORTANT:** You must wait 24 hours after applying the magnetic phone socket onto your phone or device before using FastBall™ so that the adhesive can cure properly. Using the FastBall™ sooner may cause adhesive to fail.

### HOW TO INSTALL BALL MOUNT

**NOTE:** The ball mount must be installed on a hard surface such as the hard plastic of your car dash in order to adhere properly.

1. Start by cleaning the area on your car’s dash where you will be putting the ball mount. (Figure D)

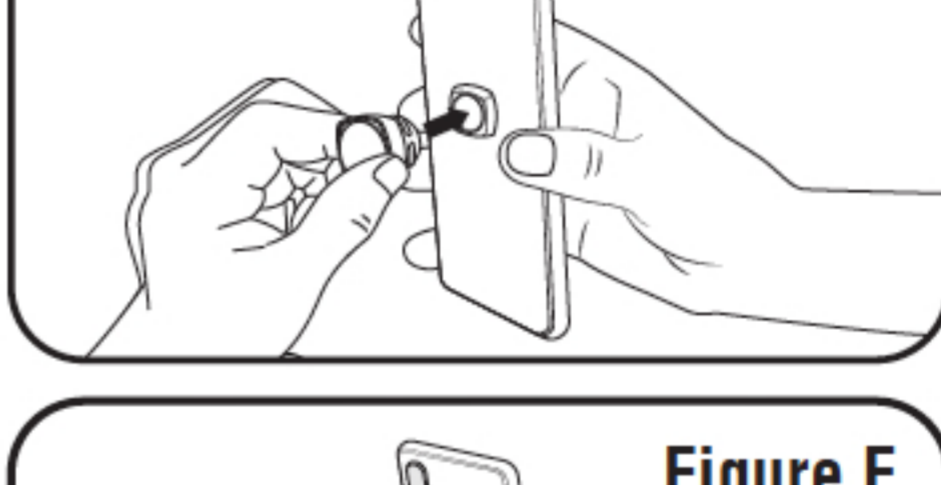

**NOTE:** Consult car maker instructions as to cleaners your car’s dash. Avoid cleaners that may scratch or corrode your car’s dash.

2. Once your car dash is clean and completely dry, test the area where you would like to install your FastBall™ ball mount before adhering it to the dash surface.



To test the location, connect the magnetic phone socket to the ball mount. (Figure F)

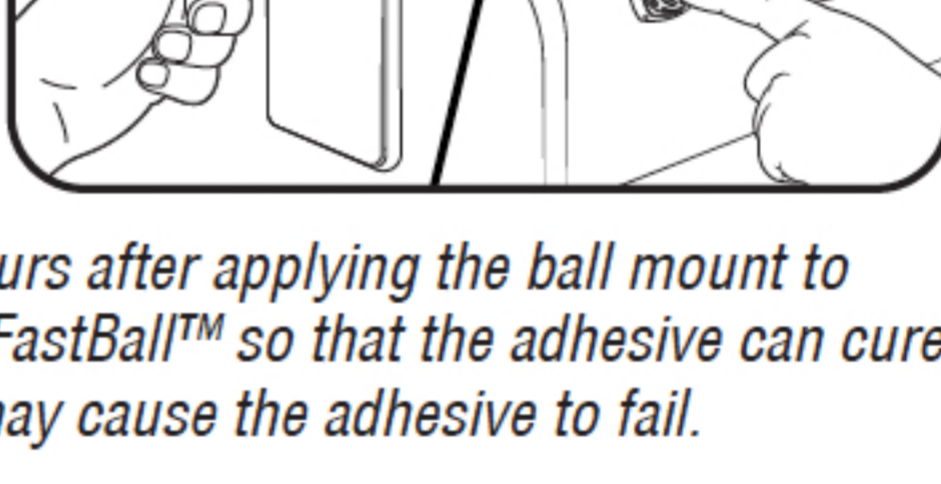

3. Once connected, hold the assembled FastBall™ over your dash to choose a location. (Figure F) Once the desired location has been chosen, peel off the protective film on the back of the ball mount and firmly press it onto the dash. (Figure G)



**IMPORTANT:** You must wait 24 hours after applying the ball mount to your car’s dashboard before using FastBall™ so that the adhesive can cure properly. Using FastBall™ sooner may cause the adhesive to fail.

### HOW TO REMOVE

1. To remove the magnetic phone socket from your phone or phone case, take a piece of taut thin string and carefully use back and forth motion of the string to remove the magnetic phone socket. (Figure H)



2. Once the string has removed the magnetic phone socket, roll away any adhesive left behind.

**NOTE:** Follow same steps to remove ball mount from dash.

**CAUTION:** To prevent damage and personal injury, **DO NOT** use sharp-edged items such as knives. Use fresh adhesive (provided) each time, instead of using old adhesive again.

### HOW TO REINSTALL

**NOTE: DO NOT** remove other side of 3M adhesives until ready to use.

1. Make sure product and application area are adhesive-free, and then install **NEW** adhesive.
2. Place the **NEW** adhesive in the middle of the magnetic phone socket and ball mount surfaces. Once centered, simply peel off one side of the 3M adhesive protective film and stick it to the back surfaces. (Figure I)



Not affiliated with or endorsed by 3M Company. 3M is a trademark of 3M Company.

Manufactured for

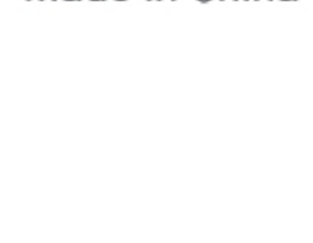

Fairfield, NJ 07004 ©2018 Telebrands www.bulbhead.com

Made in China

**LIMITATION OF LIABILITY**  
Liability limited to the purchase price of this product. Telebrands Corp. shall not be liable for any incidental or consequential damages or any implied warranty on this product. Some states do not allow the exclusion or limitation of incidental or consequential damages so the above limitation or exclusion may not apply to you.